

BANQUET & CONVENTION SPACE

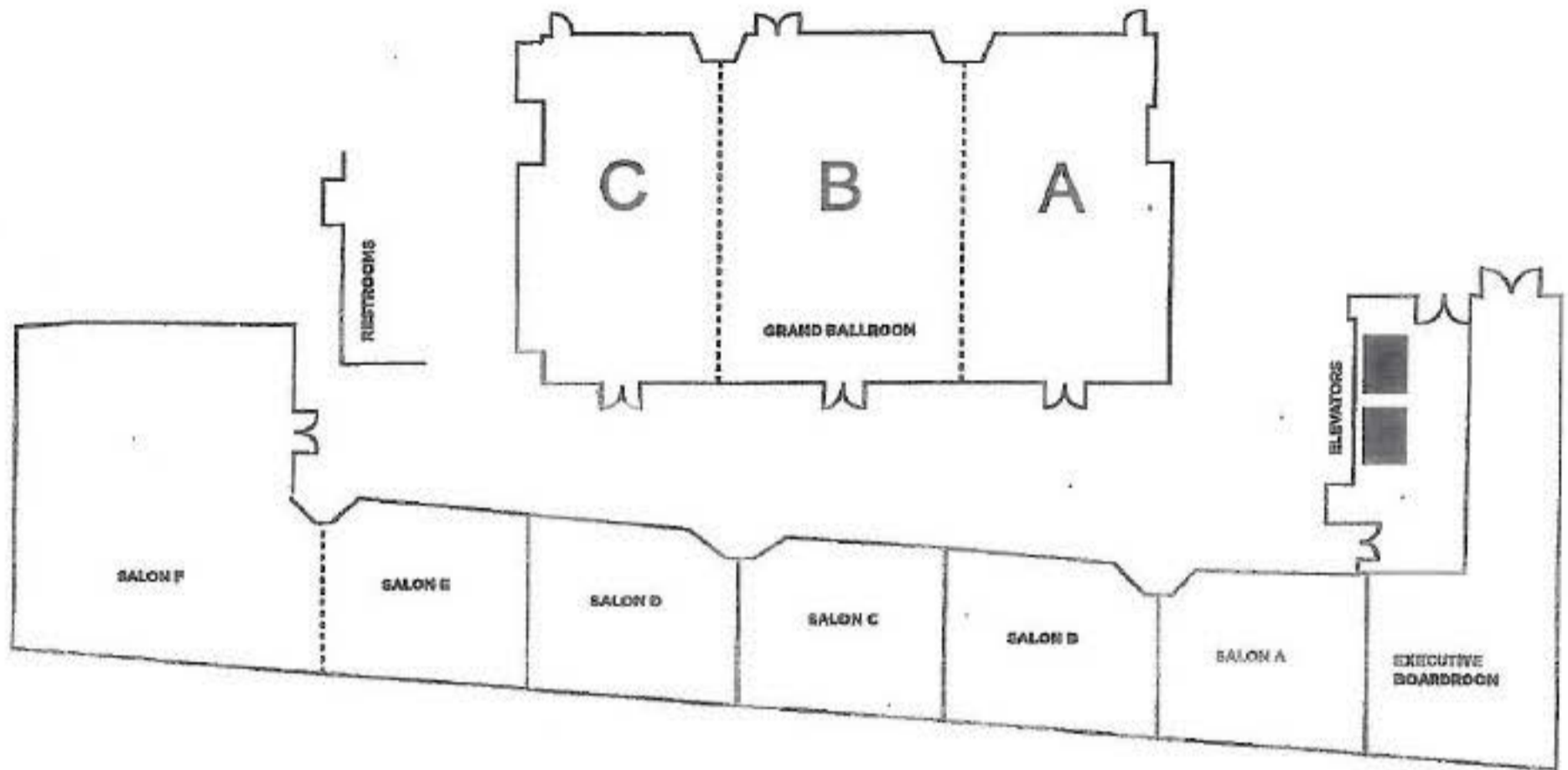

Greektown Casino-Hotel Banquet and Convention Space Details

| | Square Footage | Length | Width | Credenza Size | Ceiling Height |
|---------------------|----------------|---------|------------|---------------|----------------|
| Grand Ballroom | 3752 | 40'-8" | 92'-3" | NA | 14'-0" |
| Ballroom A | 1078 | 40'-8" | 26'-6" | NA | 14'-0" |
| Ballroom B | 1593 | 40'-8" | 39'-2" | NA | 14'-0" |
| Ballroom C | 1078 | 40'-8" | 26'-6" | NA | 14'-0" |
| Two Sections | 2671 | 40'-8" | 65'-8" | NA | 14'-0" |
| Executive Boardroom | 833 | 45'-0" | 28'-3-3/4" | NA | 9'-8" |
| Salon A | 504 | 17'-7" | 28'-8" | 6'-6" | 9'-8" |
| Salon B | 539 | 17'-10" | 30'-3" | 12'-10" | 9'-8" |
| Salon C | 533 | 18'-1" | 29'-6" | 20'-8" | 9'-8" |
| Salon D | 541 | 18'-4" | 29'-6" | 10'-9" | 9'-8" |
| Salon E | 540 | 18'-6" | 29'-2" | 20'-6" | 9'-8" |
| Salon F | 968 | 20'-2" | 48'-0" | 8'-6" | 9'-8" |
| Salon EF | 2450 | 75'-8" | 46' | 19' & 20'-6" | 9'-8" |